



THE *Fairmont*
CHATEAU LAKE LOUISE

ELEGANCE AND EXHILARATION

Awe-inspiring mountains overlooking pristine waters

Situated in Banff National Park — a UNESCO World Heritage Site in the heart of the Canadian Rockies — is magnificent Lake Louise. A place where deer roam freely on alpine trails and eagles survey a land untouched by time. Here, you can fully immerse yourself in the historic elegance of The Fairmont Chateau Lake Louise, an iconic resort enveloped by soaring mountains and embraced by a glistening emerald lake. Recognized globally for outstanding skiing and outdoor activities, and responsible tourism practices, it's an ideal gateway for adventurers and nature lovers alike; of course, exceptional amenities, including indulgent spa treatments, make it equally ideal for those seeking the ultimate retreat. Similarly, 3,340 square metres (36,000 square feet) of luxurious event space will inspire any business meeting or social function. Whatever your visit entails, 554 alpine-accented guest rooms and suites, up-to-date technology and conveniences, and impeccable service ensure that your experience is nothing short of memorable.



GUEST ROOMS AND SUITES

The natural beauty of the alpine setting permeates every one of our relaxed, well-appointed guest rooms and suites. For more information on available rooms and suites, please visit fairmont.com/lakelouise

Room and suite selections

- Fairmont Room
- Fairmont Lakeview Room
- Fairmont Mountain View Room
- Deluxe Room
- Deluxe Lakeview Room
- Junior Suite
- Junior Lakeview Suite
- One-Bedroom Suite
- One-Bedroom Lakeview Suite
- Belvedere Suite
- Two-Bedroom Mountainside Suite
- Two-Bedroom Lakeview Suite

Guest room amenities and features

- Windows that open for fresh mountain air
- Alarm clock-radio, hair dryer, iron and ironing board
- High-speed Internet access
- Cable television with in-room movies
- Coffee maker/teakettle
- Telephone with voice mail, data-line capability
- Video express checkout

Guest room facilities and services

- Wireless Internet access available hotel-wide
- Crib, rollaway bed
- In-room safety deposit boxes
- Babysitting
- Laundry and dry cleaning
- Ski storage
- Wheelchair accessibility
- Pet-friendly rooms

FAIRMONT GOLD

Welcome to a world apart. Fairmont Gold, our exclusive lifestyle hotel experience, promises special privileges, and discreet and attentive service designed to meet the needs of the most discerning corporate or leisure guest. After a \$6-million expansion in 2008, this “hotel within a hotel” features the finest guest rooms and suites in the Rocky Mountains.

Fairmont Gold room and suite selections

- Fairmont Gold Room
- Fairmont Gold Lakeview Room
- Fairmont Gold Mountain View Room
- Fairmont Gold One-Bedroom Suite
- Fairmont Gold One-Bedroom Lakeview Suite
- Fairmont Gold Junior Suite
- Fairmont Gold Junior Lakeview Suite

Fairmont Gold amenities, features and services

- Access to the exclusive Fairmont Gold Lounge
- Dedicated Fairmont Gold Concierge team
- Private check-in and checkout
- Complimentary deluxe continental breakfast, evening hors d’œuvres and honour bar
- Complimentary overnight shoe shine
- Nightly turndown service
- Access to Fairmont Gold DVD/CD library
- Laptop with Microsoft Office
- Complimentary wireless Internet access in rooms and in the lounge
- iPad access available

FOOD AND BEVERAGE CHOICES

Fairview Dining Room: The Chateau’s Four Diamond dining room, featuring the best in Canadian cuisine.

Lago Italian Kitchen: Enjoy Italian-inspired cocktails, choose from an extensive wine list and savour some of Italy’s finest food – all amid the spectacular scenery of Lake Louise.

Walliser Stube: Classic cheese and meat Swiss fondues, plus a floor-to-ceiling wine library.

Poppy Brasserie: Friendly, unpretentious service during the breakfast buffet, which features our chef’s interpretation of favourite North American family recipes.

Lakeview Lounge: Signature salads, sandwiches, quiches and tapas; artisan mixology cocktails; afternoon tea. Enjoy a small bite or a complete meal, and a perfectly stellar view.

Glacier Saloon: A journey to the Wild West of yesteryear, with local and international beers and easygoing pub meals.

Chateau Deli: Open 24 hours for delicious, fresh-made coffee, sandwiches and salads, and savoury hot dishes, all packaged to go.

In-Room Dining: Signature gourmet dishes, our “Select Vineyard” wine program and a special children’s menu.

Afternoon Tea: Signature blends, along with perfect, bite-sized finger sandwiches, buttermilk scones and homemade sweets.

SPA AND FITNESS

The Spa at The Fairmont Chateau Lake Louise Pamper yourself after a day in the great outdoors and relax in soothing surroundings. The Spa at The Fairmont Chateau Lake Louise lets you choose from a wide variety of products, salon services and treatments that will relax, rejuvenate and revitalize.

Health Club

Our fully equipped Health Club features:

- Indoor heated pool
- Whirlpool
- Steam room
- Change rooms for men and women
- Fitness centre with elliptical trainer, stair climbers, free weights, Keiser air-pressure weight machines, stationary bikes and treadmills.

FUNCTION ROOM CAPACITIES

ROOMS	OVERALL DIMENSIONS		SQUARE		HEIGHT		CAPACITIES						
	FEET	METRES	FEET	METRES	FEET	METRES	BOARDROOM	CLASSROOM	THEATRE	U-SHAPE	RECEPTION	ROUNDS OF 8	ROUNDS OF 10
MOUNT TEMPLE WING													
Mount Temple Ballroom	123 x 72	37.5 x 21.9	8,856	823	21.5	6.5	–	450	850	–	750	568	600
Mount Temple Ballroom A&B or B&C	83 x 72	25.3 x 22	5,976	555	21.5	6.5	–	288	576	88	325	384	390
Mount Temple Ballroom A,B or C	40 x 72	12.2 x 21.9	2,880	268	21.5	6.5	–	144	242	45	200	144	150
Heritage Hall	93 x 39	28.3 x 12	2,790	259	21.5	6.5	–	–	–	–	610	–	–
Beehive Trail Room	29 x 28	9 x 8.5	676	63	9.4	3	24	33	60	20	60	32	40
Lakeshore Trail Room	29 x 34	8.5 x 10.4	884	82	9.4	3	28	48	80	26	80	48	60
Beehive & Lakeshore	62 x 29	19 x 8.8	1,560	145	9.4	3	52	72	136	44	150	96	100
Plain of Six Glaciers Trail Room	29 x 34	8.5 x 10.4	884	82	10	3	28	48	80	26	80	48	60
Saddleback Trail Room	29 x 28	9 x 8.5	676	63	10	3	24	33	60	20	60	32	40
Plain of Six & Saddleback	62 x 29	19 x 8.8	1,560	145	10	3	52	72	150	54	150	96	100
Parker Room	26 x 21	7.9 x 6.4	525	49	9.4	3	20	32	40	21	30	32	30
Mollison Room	21 x 20	6.4 x 6.1	420	39	9.4	3	16	18	32	16	30	24	20
MAIN BUILDING													
Victoria Room	127 x 50	38.7 x 15.2	6,000	557	18	5.5	–	350	650	–	500	320	400
Sun Room	41 x 43	12.5 x 13.1	900	84	15	4.5	32	70	126	28	120	64	70
Captain's Room	21 x 11	6.4 x 3.4	231	21	9	3	12	–	16	–	16	8	10
Agnes Room	32 x 19	9.8 x 5.8	540	50	10	3	28	36	56	26	60	40	30
Louise Room	26 x 17	7.9 x 5.1	416	39	10.4	3	24	16	36	20	35	24	20
Lefroy Room	24 x 17	7.3 x 5.1	384	36	11	3.5	18	16	24	16	25	16	20
Pipstone Room A&B	25 x 50	7.6 x 15.2	1,250	116	11	3.5	48	72	140	48	140	80	80
Pipstone Room A	25 x 24	7.6 x 7.3	600	56	11	3.5	24	40	72	20	70	40	40
Pipstone Room B	25 x 25	7.6 x 7.6	650	60	11	3.5	24	40	72	20	70	40	40
Alpine Room	45 x 36	13.7 x 11	1,800	167	15	4.5	36	40	70	24	100	64	80
Larch Lounge	46 x 21	14.6 x 6.4	1,008	94	11	3.5	–	–	–	–	275	–	–

MEETINGS AND EVENTS

The Fairmont Chateau Lake Louise is a world-class resort in a one-of-a-kind destination. Inspire your group through authentic experiences and breathtaking surroundings. Our unique Mountain Heritage Programs and themed itineraries set the stage for memorable business meetings, encouraging participation and active knowledge; a diverse range of exhilarating activities are sure to refresh and rejuvenate. A leader in environmental stewardship, The Fairmont Chateau Lake Louise is the ultimate “back to nature” setting, complemented by invigorating health, wellness and educational programming. Historic grandeur blends with state-of-the-art technology throughout the 3,340 square metres (36,000 square feet) of flexible, inspiring function space, while our skilled Conference Services team ensures that your event is tailored to your every need.

BUSINESS SERVICES

Our Business Centre and Concierge desk are equipped to handle every request of the business traveller, with services such as faxing, photocopying, Internet access, transparencies, word processing and couriering. In addition, wireless Internet access is available in the Lobby and the Lobby Bar, in the Lakeview and Larch Lounges, in the seating area outside the Victoria Room, in the Fairmont Gold Lounge and in most of our meeting rooms. High-speed Internet access is free of charge with all Fairmont Gold accommodations.

SELECT AWARDS

Top 50 Ski Hotels
Condé Nast Traveler

Gold List 2008
Condé Nast Traveler

Readers' Choice Awards 2008
Condé Nast Traveler

Readers' Choice Platinum List,
 Top Resort in Canada
Celebrated Living

Connoisseur's Choice 2008
Resorts and Great Hotels Magazine

2008 Readers' Choice (for outstanding meeting facility and service)
Meetings West Magazine

AAA Four Diamond Award (for the hotel and the Fairview Dining Room)

2012 Wine Spectator Certificate (for the Fairview Dining Room)

TripAdvisor's Traveler's Choice Awards

Top 27 Ski Hotels, 2011
Travel & Leisure – North America's Best Ski Resorts

World Travel Awards 2011 (for Alberta's Leading Ski Resort)

THE FAIRMONT CHATEAU LAKE LOUISE

Off Site: Brewster Barn

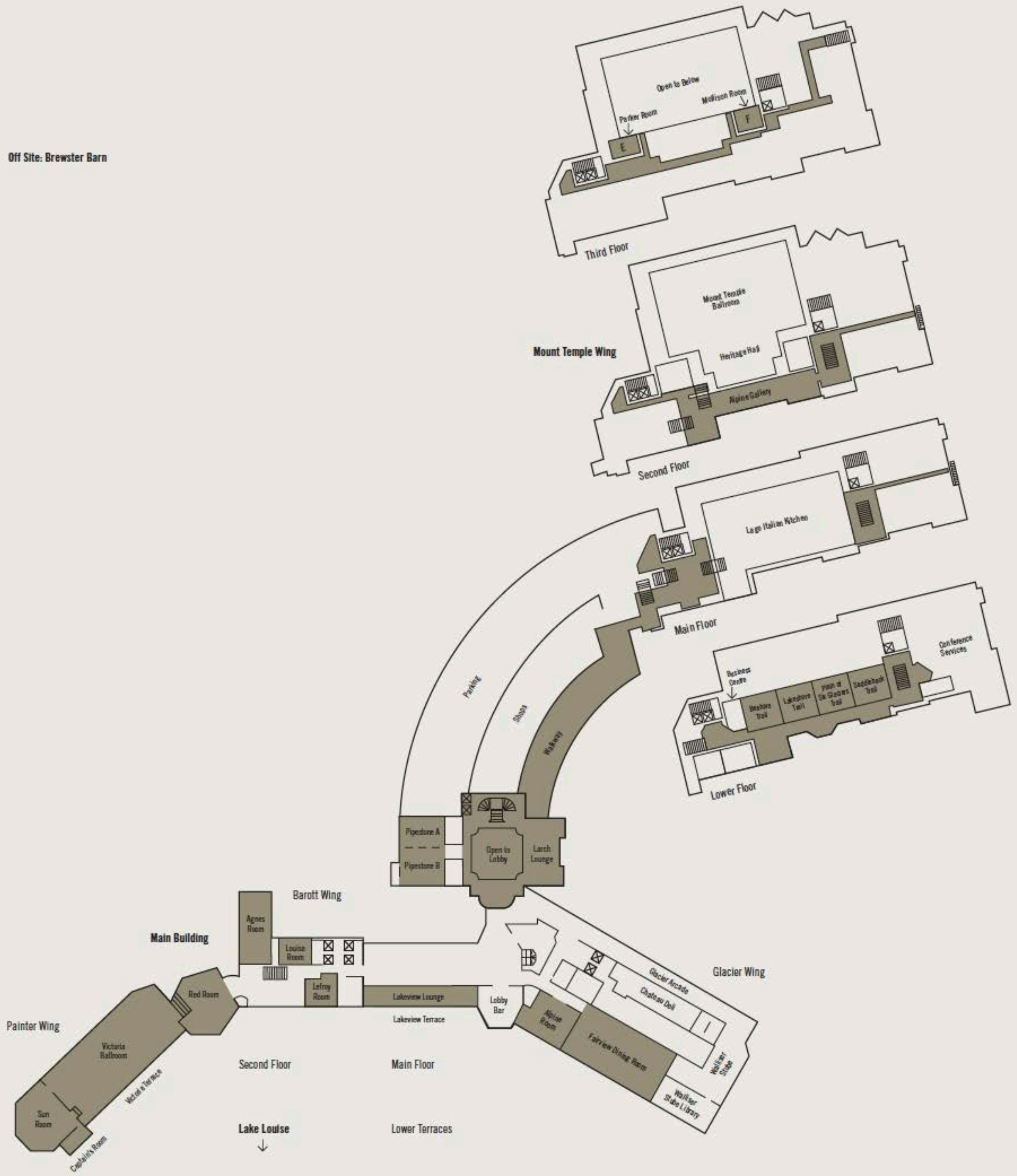

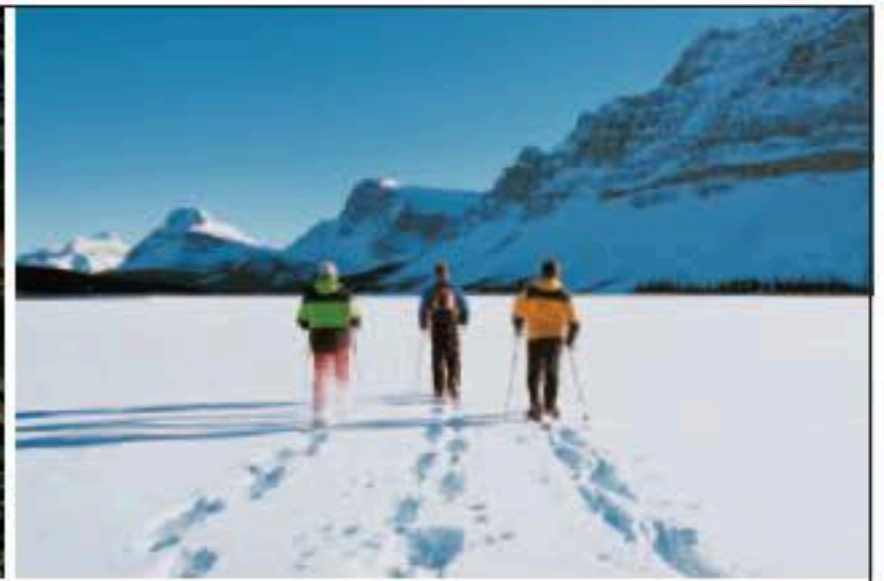
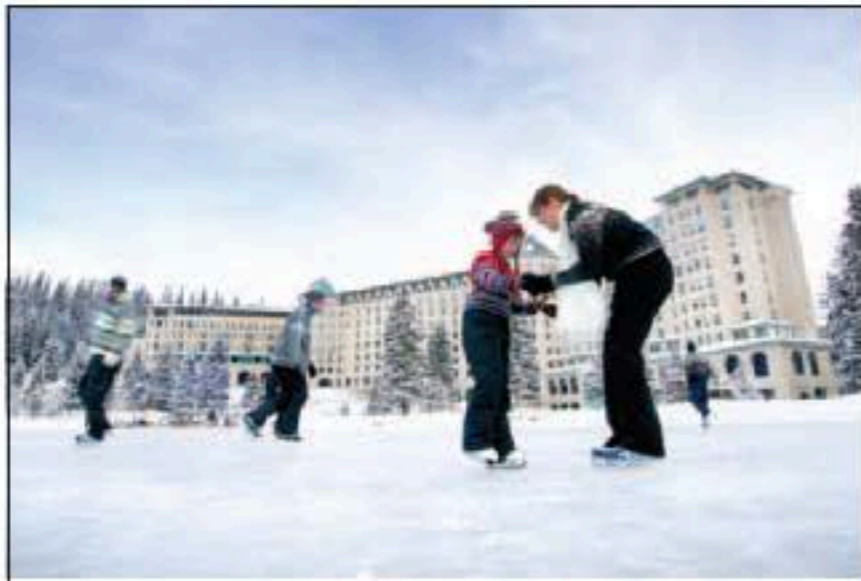

WINTER ACTIVITIES

Downhill skiing and snowboarding

Surrounded by snow-frosted Rocky Mountain peaks, and showcased by a majestic glacier, The Fairmont Chateau Lake Louise awaits your arrival. In the heart of some of the world's most extraordinary downhill areas, the ski season typically runs from mid-November to mid-May.

Lake Louise Ski Area, 10 minutes away, is one of Canada's largest ski areas, with a 990-metre (3,250-foot) vertical drop, spread over four mountain faces, over 1,700 skiable hectares (4,200 acres) and 113 named runs. For the past decade, Lake Louise has been the host site for the Men's and Women's World Cup ski races.

Sunshine Village, only 40 minutes away, is a vast bowl of deep snow that averages 9 metres (30 feet) of powder from November to June — the longest ski season in Canada.

Banff's Mount Norquay, located 45 minutes away, above the town of Banff, offers a wide range of terrain and the rare experience of night skiing.

Kicking Horse Resort — with many winter activities, including skiing and tubing — is a short drive into British Columbia.

Cross-country and heli-skiing

Take in the breathtaking views along the cross-country trails, accessible from your doorstep, or book an extreme adventure and the ultimate thrill — heli-skiing.

Other winter activities

- Hiking
- Johnston Canyon Winter Walks
- Snowshoeing
- Ice-skating
- Dog sledding
- Horse-drawn sleigh rides
- Mountain Heritage Winter Program

Following an exhilarating day of outdoor adventures, warm up with a massage or relax with a facial in our full-service spa.

SUMMER ACTIVITIES

Whether you're hiking a switchback, looking down on the turquoise waters of Lake Louise or biking through mountain terrain, summer offers a wealth of spectacular alpine adventures. Choose from activities such as:

- Hiking
- Canoeing, whitewater rafting, fishing and boat cruises
- Mountain Heritage Summer Program
- Horseback riding
- Mountain biking
- Rocky Mountain gondola sightseeing rides
- Fly fishing on the Bow River
- Golf
- Columbia Icefield & Brewster Ice Explorer
- ATV tours.

After an exciting day of outdoor adventures, enjoy a facial or foot treatment in our full-service spa.

MORE THAN A CENTURY OF OUTDOOR ADVENTURE

"A hotel for the outdoor adventurer and alpinist" was the philosophy behind the original Lake Louise Chalet, built in 1890 — a philosophy that continues to this day. Over the following century, the original property saw several expansions and transformations. In 2004, the new Mount Temple Wing was completed. Designed to meet the needs of modern business, while paying tribute to the centuries-old heritage and the protected wildlife of Banff National Park, this iconic hotel is a year-round destination for all who seek the beauty of nature combined with the ultimate in modern comforts.

EXPLORING BANFF AND LAKE LOUISE

Apart from the splendid outdoor and sightseeing opportunities afforded by Banff National Park and Lake Louise, you can experience a true sampling of the Canadian Rockies within the hotel itself — with over 20 specialty shops showcasing custom hotel merchandise, Canadian Native Indian and Inuit art, fashions woven from the famous Canadian Arctic muskox, beautifully crafted jewellery and watches, quality brand-name outerwear and casual clothing, candy and maple products, plus books, posters and gifts that capture our heritage. Five minutes away, you will find additional shopping and services in Lake Louise village; 45 minutes away is the village of Banff.

AVERAGE

TEMPERATURES

(Celsius/Fahrenheit)	high °C/F	low °C/F
Winter	2/36	-12/10
Summer	25/77	7/45

GENERAL INFORMATION

- Time zone: Mountain Standard Time (UTC -7:00 hours)
- Currency: Canadian dollar (CAD)
- Taxes: 2% Tourism Improvement Fee, 4% Provincial Hotel Tax, 5% Goods and Services Tax (GST)

TRANSPORTATION OPTIONS:

- Brewster Coach
- Sundog Shuttles
- Car rental at Calgary International Airport and at The Fairmont Chateau Lake Louise

Getting to The Fairmont Chateau Lake Louise

Choose from shuttle transfer, taxi, private-car service or car rental. For assistance with your transportation booking, please contact our concierge.

From Calgary International Airport (about 2 hours):

- When exiting the Calgary Airport, turn left onto Barlow Trail NE
- Turn left onto 96 Ave NE
- Merge onto Deerfoot Trail/Highway #2 North
- Follow Deerfoot Trail/Highway #2 North to exit ramp and onto Stoney Trail West
- Take exit 36 for AB-1 W/Trans-Canada Highway W toward 16 Avenue N/Banff
- 16th Avenue becomes Trans-Canada Highway 1, which takes you straight to Banff (a 45- to 60-minute drive)
- In Banff National Park, follow the signs for the hamlet of Lake Louise, continuing on the Trans-Canada Highway. (note: there is an entrance fee at the park gates)
- 40 minutes past the town of Banff, take the turnoff marked for Lake Louise.
- Turn left at the intersection, proceed through two stop signs and continue on this road for 4 kilometers (2.4 miles).



THE *Fairmont*
CHATEAU LAKE LOUISE

111 Lake Louise Drive
Lake Louise, Alberta
Canada T0L 1E0
TEL +1 403 522 3511
TOLL FREE +1 866 540 4413
FAX +1 403 522 3834
E-MAIL chateaulakelouise@fairmont.com

For reservations contact:
1 800 441 1414 or visit fairmont.com



Fairmont Hotels & Resorts has been a WWF Climate Savers partner since 2009 and has committed to reducing its emissions by 20% below 2006 levels by 2013.